

Introducing Portland's

East End Community School

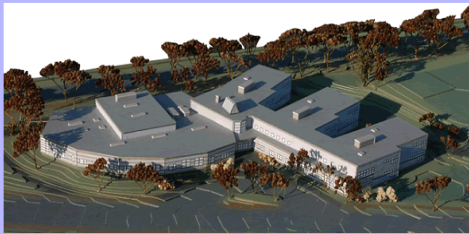

Portland Public Schools

*Assuring that all students
are learning for their future*

www.portlandschools.org



What's Unique about the East End Community School?

- First K-5 school of choice
- Small school atmosphere
- Expeditionary Learning
- Responsive Classroom approach
- Coherent grouping, K through 5
- Transportation provided by PPS
- Interdisciplinary studies
- Emphasis on literacy instruction
- Strong focus on Allied Arts
- Natural lighting
- Energy efficient building

Planned programming for our new school:

The **East End Community School** is Portland's first elementary school of choice. Both the learning space and the programming have been designed to give students increased opportunities to learn through in-depth interdisciplinary studies with a strong arts component.



A strong, research based **literacy program** will support the use of Expeditionary Learning.

This **student-centered** methodology is highly responsive to each child's learning profile. Two credentialed literacy coaches work with teachers both in and out of the classroom to help them increase their instructional effectiveness.



Each of the three wings of the school will have the characteristics of a **small school atmosphere**. Students will remain in the same wing from grade one through five, thus assuring the opportunity for building

strong communities, within the school itself, and extending out to the surrounding community as well.

Each wing will be semi-autonomous with regard to designing and executing programming. As the most important member of their children's learning team, **parents** will be invited to collaborate with teachers.

The East End Community School will use **Expeditionary Learning** as the framework for learning. It emphasizes active involvement, character growth and team building. The hallmark of Expeditionary Learning is the learning expedition. Expeditions are challenging, interdisciplinary, real work projects



and in-depth studies that act as primary curriculum units. The expeditions are the venue within which students work toward achieving the standards of the **Learning Results** in reading, mathematics, and the content areas.



The techniques of the **Responsive Classroom** approach will be practiced to create and maintain a **positive school culture**. The use of this approach is intended to

build and refine students' social skills and academic engagement, and establish the positive classroom and school climate that supports increased learner investment and independence.

The East End Community School will emphasize the **arts** as an integral part of all of our expeditions. A performance arts teacher will work with classrooms to incorporate theater into the curriculum. Local art institutions will provide additional expertise to enhance our programming.



For more information contact:
Carol Dayn, Principal
Telephone: (207) 874-8228
daync@portlandschools.org